

Over-Support Splice Adaptor

- Place splices directly over supports
- No additional support required



Over-Support
Splice Adaptor
(Beam Installation)

Standard 1/4 Span Typical Installation

Based on NEMA VE2

Supports are placed at 1/4 span (25%).

Supports should be located within 2 feet of each side of expansion splice plates.

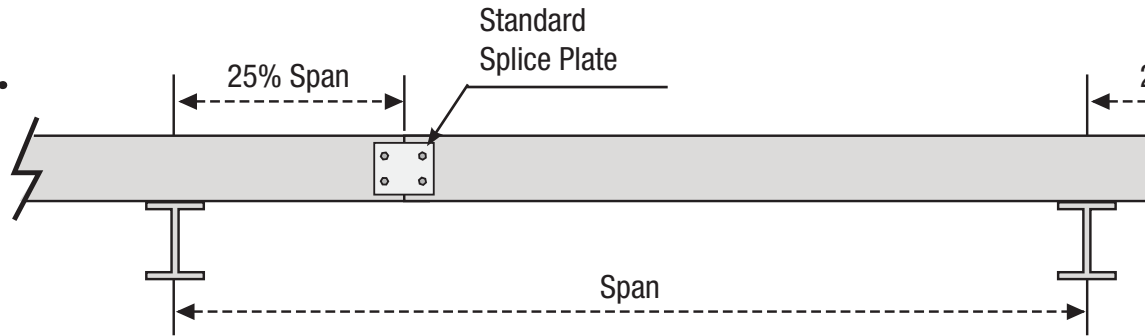

T&B Over-Support Installation method

Supports are placed right under the joints of the installation.

The splice adaptor allows a wider distribution of the support, therefore minimizing the stress and deflection of the assembly.

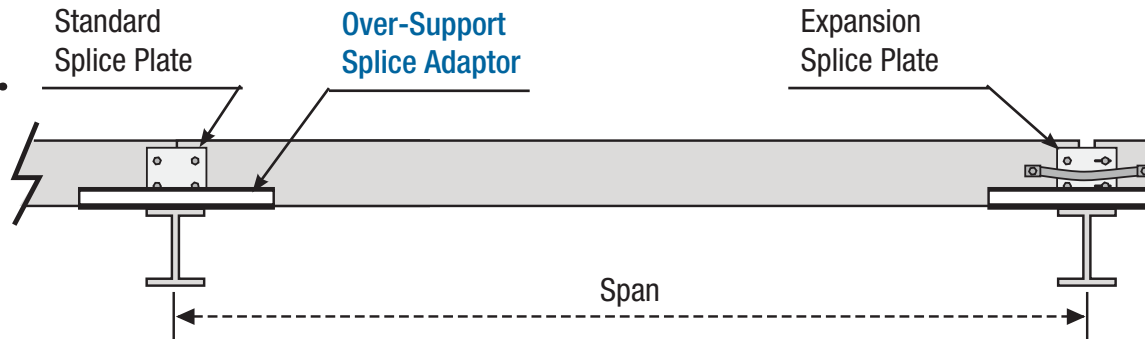

Over-Support Splice Adaptor Beam Installation – ABW46-OSS-B

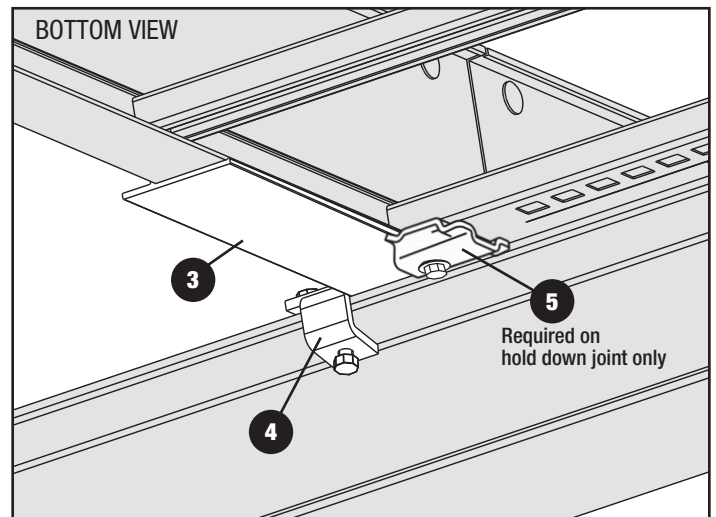
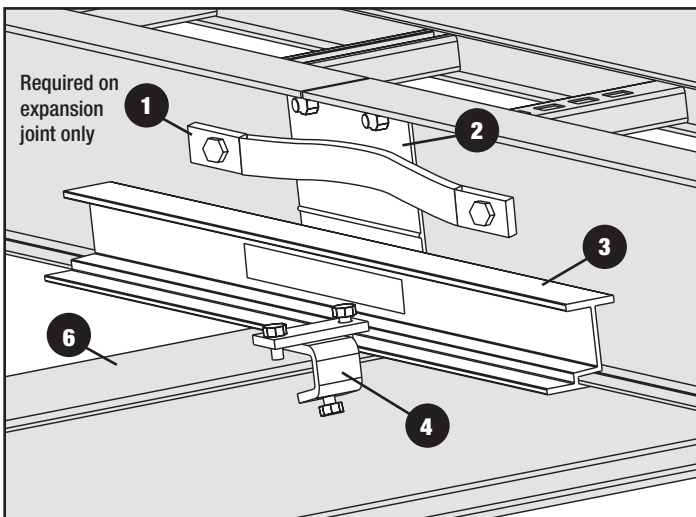

Installation Components

- | | |
|--------------------------------|---------------------------|
| 1. Bonding jumper | 5. Hold down clamp |
| 2. Splice plate | 6. Structural beam |
| 3. Over-support splice adaptor | 7. Strut (see right page) |
| 4. Beam clamp | |

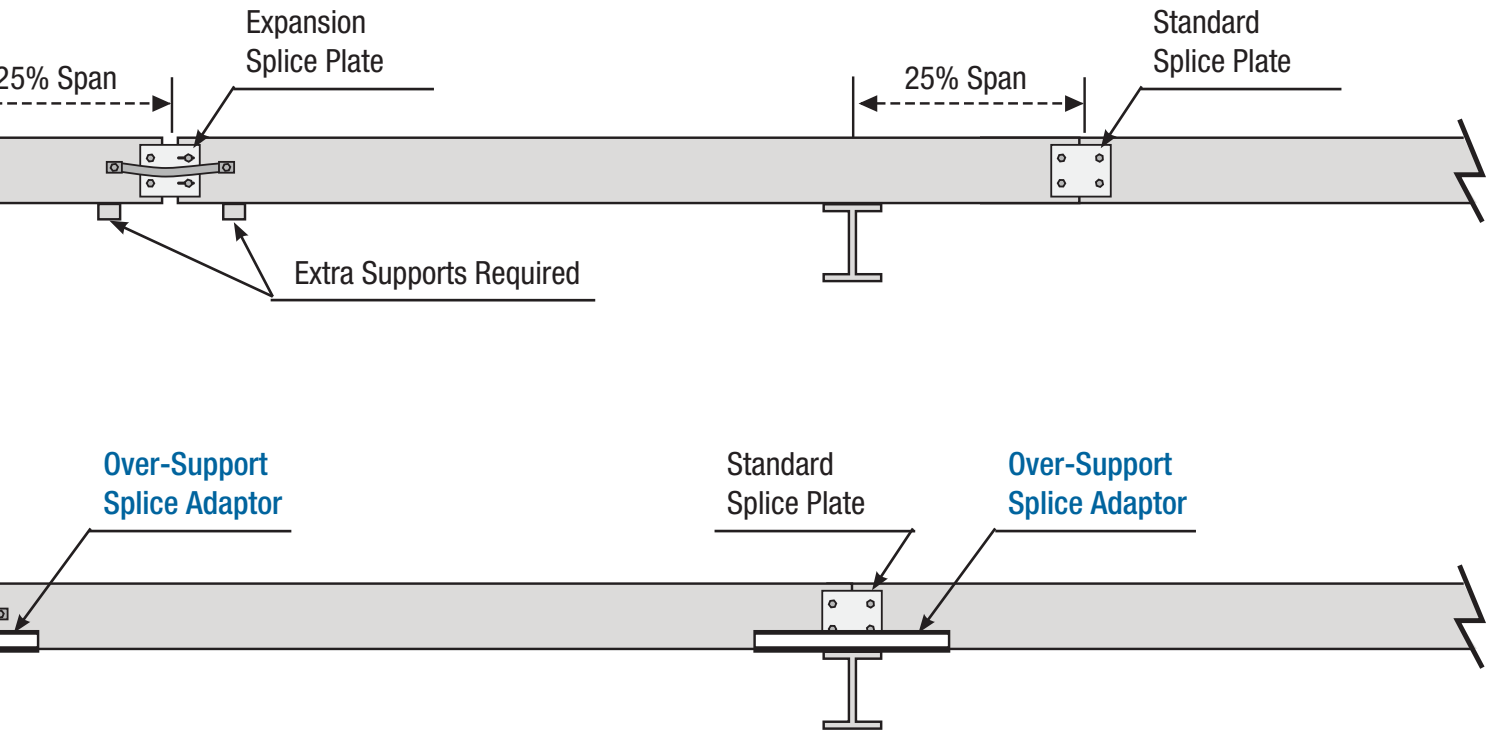

NEMA VE2: Splice joints should be designed and placed so as to maximize the rigidity of the cable tray over support. Splice plates and adaptors are part of a system specifically designed for placement directly over supports.

Over-Support Splice Adaptor Strut Installation – ABW46-OSS-S

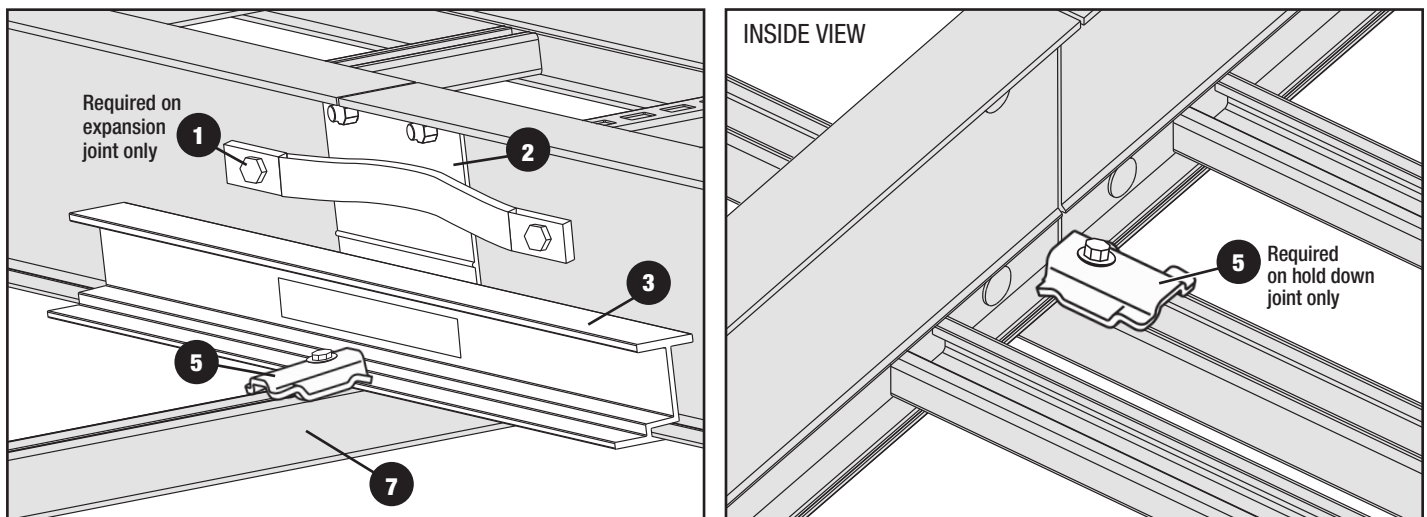

Cable Tray Installation

- For gap setting at expansion joint, refer to NEMA chart on the back cover.
- Every tray-support joint must have a pair of over-support splice adaptors (both standard splices and expansion splices).

ABW46-OSS-B

Over-Support Splice Adaptor – Beam Installation

Expansion over support beam 29 in.	2
SHWCTC, Heavy-duty hold down clamp (complete with mounting hardware)	2
ABWCHGC, Combination Hold Down / Expansion Guide Clamp	2
E142-3/8X100EG, 3/8 in. – 16 x 1 in. hex cap screws	2
AC100-3/8EGC, 3/8 in. strut nut	2

NOTE: Every expansion joint requires the use of a bonding jumper such as FBD16-1 (16 in., 600 A)

ABW46-OSS-S

Over-Support Splice Adaptor – Strut Installation

Expansion over support beam 29 in.	2
ABWCHGC, Combination Hold Down / Expansion Guide Clamp	4
E142-3/8X100EG, 3/8 in. – 16 x 1 in. hex cap screws	4
AC100-3/8EGC, 3/8 in. strut nut	4

NOTE: Every expansion joint requires the use of a bonding jumper such as FBD16-1 (16 in., 600 A)

Over-Support Splice Adaptor – Safe Working Load

Cable Tray Series	Safe Load Rating When Used with ABW46-OSS at 20-ft. Span
AH36	80 lb./ft.
AH46	100 lb./ft.
AH56	120 lb./ft.
AH66	165 lb./ft.

Expansion Plate Gap Chart

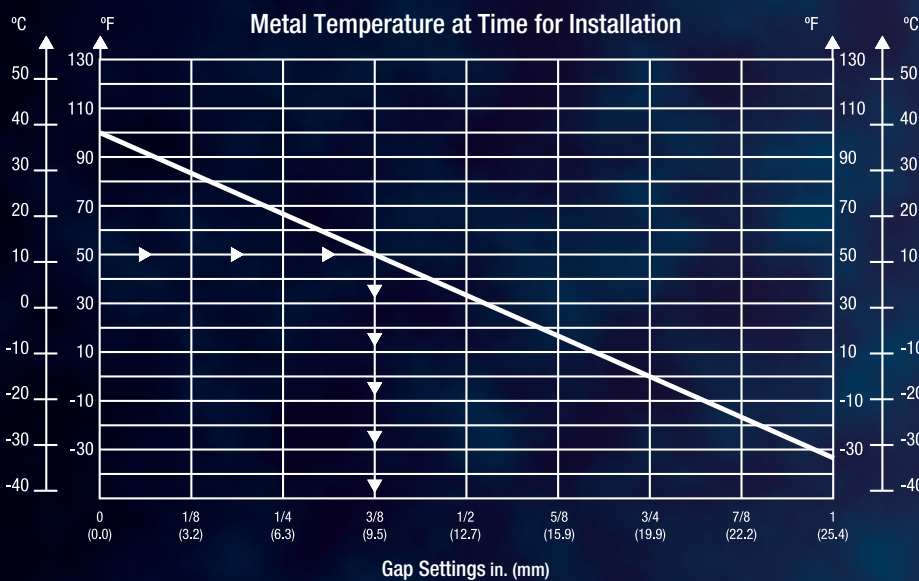

Atlantic Provinces
Thomas & Betts Limited
 Tel.: (902) 450-1307
 Toll Free: 1-877-862-4357
 Fax: (902) 450-1309

Quebec
Thomas & Betts Limited
 Tel.: (450) 466-1102
 Toll Free: 1-800-465-1399
 Fax: (450) 466-1163

Ontario
Thomas & Betts Limited
 Tel.: (905) 858-1010
 Toll Free: 1-877-291-7771
 Fax: (905) 858-1080

Manitoba/Saskatchewan
Thomas & Betts Limited
 Tel.: (604) 598-9811
 Toll Free: 1-866-540-8220
 Fax: (604) 598-9840

Alberta
Thomas & Betts Limited
 Tel.: (780) 424-7092
 Toll Free: 1-888-664-5666
 Fax: (780) 424-7093
 Toll Free: 1-866-424-4082

British Columbia
Thomas & Betts Limited
 Tel.: (604) 598-9811
 Toll Free: 1-866-540-8220
 Fax: (604) 598-9840