

## Compression Connectors — Quick Reference

### Type WR

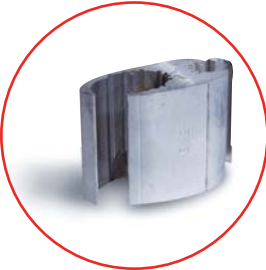

Wide Range  
Compression Connectors

pp. 38–44

### Type CF

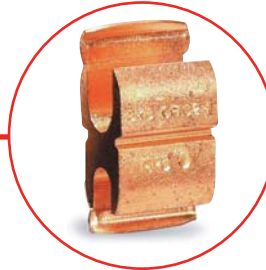

Copper Compression  
Tap Connectors

p. 45

### Type C



Compression Tap  
Covers

p. 46

### Type CTL



Copper Short Barrel  
Connectors

p. 47

### Type CTL-L, LCN



Copper Long Barrel  
Connectors

pp. 48–50

### Type CU, CSP



Copper  
Compression Splices

pp. 51–52

### Type ATL



Aluminum  
Compression Connectors

pp. 53–54

### Type ASP



Aluminum Splices

p. 55

### Type PA

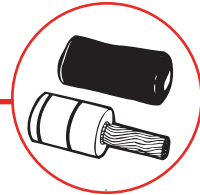

Pin Adapter  
Terminals

p. 56

### Wedge Clamps



p. 57

## Compression H-Taps Connectors

Compression Connectors

### Type WR — Wide Range Aluminum Tap Connectors

#### "O" and "D" Die Seven Connector Program

- For combinations of aluminum-aluminum and aluminum-copper conductors
- Pass the requirements of ANSI C119.4
- Standard compression tools and dies install all sizes
- Seven Connector Program provides superior connector performance, lower connection costs and simplified installation procedures
- Fold-in tabs provide positive tab interlock as tool closes
- Field-proven ribbed design provides unparalleled connector/conductor contact, without distorting the conductor's shape
- Made of 1350 aluminum alloy
- Pre-filled with an oxide inhibitor which is held captive in the rib/connection area
- For copper to copper combinations, use CF type shown on page 45.
- CSA Certified

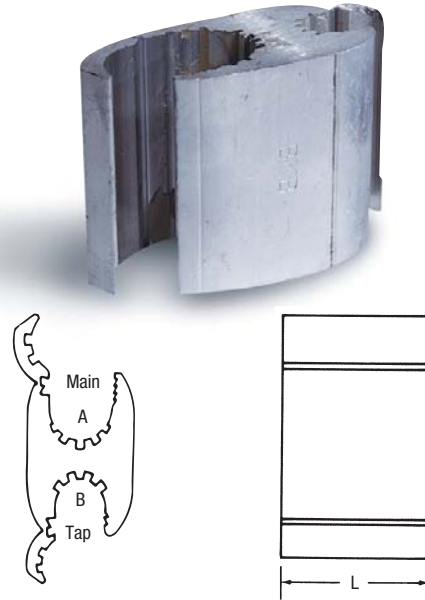

#### Type WR — "O" and "D" Die Seven Connector Program



Cat. No.	Connector No.	Conductor Range												Connector Length L (in.)	Installation Information				
		Standard Conductor						Compact Conductor				Diameter (in.)			Connector Die	No. Indents			
		Main			Tap			Main		Tap		max.	min.			max.	min.	Mech. Tool	Hyd. Tool
		ACSR	Str.	Sol.	ACSR	Str.	Sol.	ACSR	Str.	ACSR	Str.								
WR159	1	2	1	2	2	1	2	2	1	2	1	0.332	0.162	0.332	0.162	1-7/16	O		
		3	3	3	3	3	3	3	3	3	3								
		4	4	4	4	4	4	4	4	4	4								
		6	6	6	6	6	6	6	6	6	6								
WR189	2	1/0	2/0	3/0	2	1	1/0	2/0	2/0	1	1	0.419	0.266	0.332	0.162	1-11/16	O	5	2
		1	1/0	2/0	3	2	2	1/0	1/0	2	2								
		2	1	1/0	4	4	4	1	1	4	4								
		3	2	1	6	6	6	2	2	6	6								
WR289	3				2	1	1/0			1	1	0.470	0.398	0.332	0.162	1-13/16	D	5	2
					3	2	2			2	2								
					4	4	4	3/0	3/0	4	4								
		2/0	3/0	4/0	6	6	6	2/0	30	6	6								
WR279	4	2/0	3/0	4/0	2/0	3/0	3/0	3/0	3/0	3/0	0.470	0.336	0.470	0.36	1-13/16	D	5	2	
		1/0	2/0	3/0	1/0	2/0	2/0	2/0	2/0	2/0									
		1	1/0	2/0	1	1/0	2/0	1/0	1/0	1/0	1/0								
WR379	5				2	1	1/0			1	1	0.563	0.475	0.332	0.162	1-13/16	D	5	2
					3	2	2	266-18/1	266	2	2								
					4	4	4	250	250	3	3								
		4/0	4/0	—	6	6	6	4/0	4/0	6	6								
WR399	6	4/0	4/0	—	2/0	2/0	3/0	266-18/1	266	2/0	3/0	0.563	0.461	0.447	0.338	2-3/16	D	6	2
		3/0	3/0		1/0	1/0	2/0	4/0	250	1/0	2/0								
					1	1	1	3/0	4/0		1/0								
WR419	7	4/0	4/0	—	4/0	4/0	—	266-18/1	266	266-18/1	266	0.563	0.461	0.563	0.461	2-7/16	D	7	3
		3/0	3/0		3/0	3/0		4/0	250	4/0	250								
								3/0	4/0	3/0	4/0								

## Compression H-Taps Connectors

Compression Connectors

### Type WR — Wide Range Aluminum Tap Connectors

#### Supplemental "O" and "D" Die Seven Connector Program

- For combinations of aluminum-aluminum and aluminum-copper conductors
- Pass the requirements of ANSI C119.4
- Standard compression tools and dies install all sizes
- Seven Connector Program provides superior connector performance, lower connection costs and simplified installation procedures
- Fold-in tabs provide positive tab interlock as tool closes
- Field-proven ribbed design provides unparalleled connector/conductor contact, without distorting the conductor's shape
- Made of 1350 aluminum alloy
- Pre-filled with an oxide inhibitor which is held captive in the rib/connection area
- For copper to copper combinations, use CF type shown on page 45.

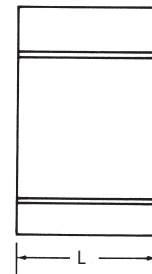
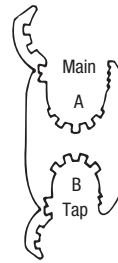

Products on this page are not CSA Certified.

### Type WR — Supplemental "O" and "D" Die Connectors

Cat. No.	Conductor Range												Connector Length L (in.)	Installation Information				
	Standard Conductor						Compact Conductor							Connector Die	No. Indents			
	Main			Tap			Main			Tap					Mech. Tool	Hyd. Tool		
	ACSR	Str.	Sol.	ACSR	Str.	Sol.	ACSR	Str.	ACSR	Str.	max.	min.					max.	min.
<b>WR149</b>	4 4 6	3 4 6	2 3 6	4 4 6	3 4 6	2 3 6	4 4 6	4 4 6	3 3 6	2 3 6	0.266	0.162	0.266	0.162	1-1/2	D	5	2
<b>WR179</b>	1/0 1 2 3	1/0 1 2	1	4 6	3 4 6	2 3 6	1/0 1 2	2/0 1/0 2	1 1/0 1 2	2 3 4 6	0.398	0.266	0.266	0.162	1-3/4	D	5	2
<b>WR199</b>	1/0 1 2 3	1/0 1 2	1	2 3 4	1 2 3 4	1 2	1/0 1 2	2/0 1/0 2	1 1 3 4	2 1 2	0.398	0.066	0.332	0.232	1-3/4	D	5	2
<b>WR1010</b>	1/0 1 2 3 4	2/0 1/0 1 2 3 4	1 2	1/0 1 2 3 4	2/0 1/0 1 2 3 4	1 2	2/0 1/0 1 2 3 4	2/0 1/0 1 2 3 4	2/0 1/0 1 2 3 4	2/0 1/0 1 2	0.419	0.232	0.419	0.232	1-3/4	D	4	2
<b>WR259</b>	1/0 1	2/0 1/0	-	1/0 1	2/0 1/0	-	2/0 1/0	2/0 1/0	2/0 1/0	2/0 1/0	0.419	0.326	0.412	0.292	1-7/8	D	5	2
<b>WR299</b>	2/0 1/0	3/0 2/0	-	4 6	3 4 6	2 3 6	3/0 2/0	3/0	4 6	2 3 4 6	0.470	0.398	0.266	0.162	1-1/2	D	4	2
<b>WR219</b>	1/0 1	1/0 1	-	1/0 1 2	1/0 1	-	1/0	2/0 1/0	1/0	2/0 1/0	0.398	0.324	0.398	0.316	1-7/8	D	5	2
<b>WR239</b>	2/0 1/0	2/0 1/0	-	2 3 4	1 2 3	1 2	2/0 1/0	4/0 3/0	1 2 3 4	1 2	0.447	0.365	0.332	0.236	1-7/8	D	5	2
<b>WR229</b>	2/0	3/0 2/0	-	1/0 1 2	1/0 1	-	3/0 2/0	3/0	1/0 1	2/0 1/0	0.470	0.410	0.398	0.316	1-7/8	D	5	2
<b>WR269</b>	2/0	2/0	-	2/0 1/0	2/0 1/0	-	2/0	3/0	2/0 1/0	3/0 2/0 1/0	0.447	0.410	0.447	0.336	1-7/8	D	5	2

## Compression H-Taps Connectors

Compression Connectors

### Type WR — Wide Range Aluminum Tap Connectors

#### Supplemental "O" and "D" Die seven Connector Program

- For combinations of aluminum-aluminum and aluminum-copper conductors
- Pass the requirements of ANSI C119.4
- Standard compression tools and dies install all sizes
- Seven Connector Program provides superior connector performance, lower connection costs and simplified installation procedures
- Fold-in tabs provide positive tab interlock as tool closes
- Field-proven ribbed design provides unparalleled connector/conductor contact, without distorting the conductor's shape
- Made of 1350 aluminum alloy
- Pre-filled with an oxide inhibitor which is held captive in the rib/connection area
- For copper to copper combinations, use CF type shown on page 45.

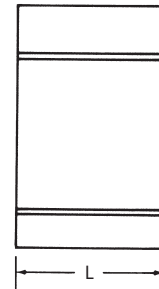
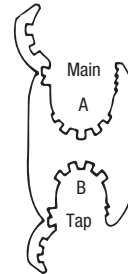

Products on this page are not CSA Certified.

Cat. No.	Conductor Range												Connector Length L (in.)	Installation Information				
	Standard Conductor*						Compact Conductor				Diameter (in.)			Connector Die	No. Indents			
	Main			Tap			Main		Tap		max.	min.			max.	min.	Mech. Tool	Hyd. Tool
	ACSR	Str.	Sol.	ACSR	Str.	Sol.	ACSR	Str.	ACSR	Str.								
<b>WR319</b>	3/0	3/0	—	2 3 4	1 2 3 4	1 2	3/0	4/0	1 2 3 4	1 2	0.502	0.461	0.332	0.229	1-7/8	D		
<b>WR339</b>	3/0	3/0	—	2/0 1/0 1	2/0 1/0	—	3/0	4/0	2/0 1/0	3/0 2/0 1/0	0.502	0.461	0.447	0.336	2-1/8	D	6	2
<b>WR359</b>	4/0 3/0	4/0 3/0	—	4 6	3 4 6	2 3 4 6	266 4/0 3/0	266 250 4/0	1/0 1 2	1/0 1 2	0.563	0.461	0.266	0.162	1-7/8	D	4	2
<b>WR369</b>	4/0 3/0	4/0 3/0	—	1 2 3 4	1/0 1 2 3	1	266 4/0 3/0	266 250 4/0	1/0 1 2	1/0 1 2	0.563	0.461	0.374	0.266	1-7/8	D	4	2
<b>WR369**</b>	4/0 3/0 2/0	4/0 3/0	—	1/0 1 2 3 4	1/0 1 2 3 4	1/0	266 4/0 3/0	266 250 4/0 3/0	1/0 1 2 3 4	1/0 1 2	0.63	0.423	0.3763	0.232	1-7/8	D	5	2
<b>WR389</b>	4/0 3/0	4/0 3/0	—	2/0 1/0	3/0 2/0	—	266 4/0 3/0	266 250 4/0	3/0 2/0	3/0 2/0	0.563	0.461	0.470	0.376	2-3/16	D	6	2
<b>WR389**</b>	4/0 3/0 2/0	4/0 3/0	—	2/0 1/0 1	3/0 2/0 1/0	—	266 4/0 3/0	266 250 4/0	3/0 2/0 1/0	3/0 2/0 1/0	0.563	0.423	0.470	0.336	2-3/16	D	6	2

\*Will accept conductors of these same wire sizes with a 3% reduction of diameter (compressed).  
 \*\*This range possible only when crimped with hydraulic tool TBM14M or JB12B.

## Compression H-Taps Connectors

Compression Connectors

### Type WR — Wide Range Aluminum Tap Connectors “N” Die for Hydraulic Tools, 12-Ton and Greater

- For combinations of aluminum-aluminum and aluminum-copper conductors
- Pass the requirements of ANSI C119.4
- Standard compression tools and dies install all sizes
- Seven Connector Program provides superior connector performance, lower connection costs and simplified installation procedures
- Fold-in tabs provide positive tab interlock as tool closes
- Field-proven ribbed design provides unparalleled connector/conductor contact, without distorting the conductor's shape
- Made of 1350 aluminum alloy
- Pre-filled with an oxide inhibitor which is held captive in the rib/connection area
- For copper to copper combinations, use CF type shown on page 45.

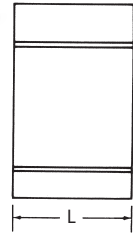
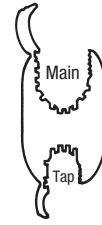
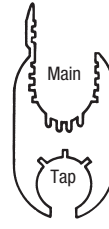

Fig. 1

Fig. 2

Products on this page are not CSA Certified.

Cat. No.	Conductor Range												Connector Length L (in.)	Installation Information					
	Standard Conductor*					Compact Conductor				Diameter (in.)				For Use with Tool	No. of Indents				
	Main		Tap			Main		Tap		Main		Tap							
	ACSR	Str.	ACSR	Str.	Sol.	ACSR	Str.	ACSR	Str.	max.	min.	max.				min.			
<b>WR715</b>	397-18/1 336 300 266 250	400	2/0	2/0	3/0	477 397 336	500	2/0	3/0	0.753	0.520	0.447	0.162	2	TBM12, JB12B and Y-35	2			
		397	1/0	1/0	2/0		477	1/0	1/0										
		350	1	1	1		477	1	1										
		336	2	2	2		397	2	2										
		300	3	3	3		336	3	3										
<b>WR775</b>	397-18/1 336 266 4/0	400	397-18/1 336 266 4/0	400	-	500	477 397 336 266 250	477	500	0.743	0.520	0.743	0.520	3	TBM12, JB12B and Y-35	3			
		397		397		400													
		350		350		400													
		336		336		397													
		300		300		336													
<b>WR815</b>	477-18/1 397 336 266 4/0	556	2/0	2/0	3/0	556 477 397 350 336 266 250	556	2/0	3/0	0.858	0.520	0.447	0.162	2	TBM12, JB12B and Y-35	2			
		500	1/0	1/0	2/0		477	1/0	1/0										
		400	1	1	1		397	1	1										
		397	2	2	2		350	2	2										
		336	3	3	3		336	3	3										
<b>WR835</b>	477-18/1 397 336 266 4/0	556	4/0	4/0	4/0	556	266	556	250	0.858	0.520	0.563	0.368	2	TBM12, JB12B and Y-35	2			
		500		3/0		3/0		4/0									477	4/0	4/0
		400		3/0		3/0		3/0									397	3/0	3/0
		397		2/0		2/0		2/0									350	2/0	2/0
		336		1/0		1/0		1/0									336	1/0	1/0
<b>WR875**</b>	477-18/1 397 336 266 4/0	556				556	397 336 266	400	250	0.858	0.520	0.684	0.520	3	TBM12, JB12B and Y-35	3			
		500				397		350											
		400				350		336											
		397				336		300											
		336				266		250											
<b>WR885</b>	477-18/1 397 336 266 4/0	500				556	556 477 397 350 336 300 266 250	556	250	0.814	0.520	0.814	0.520	3	TBM12, JB12B and Y-35	3			
		400				477		397											
		397				397		350											
		336				350		336											
		266				336		300											

\* Will accept conductors of these same wire sizes with a 3% reduction of diameter (compressed).  
\*\* Not reversible (Fig. 2)

## Compression H-Taps Connectors

Compression Connectors

### Type WR — Wide Range Aluminum Tap Connectors “N” Die for Hydraulic Tools, 10-Ton and Greater

- For combinations of aluminum-aluminum and aluminum-copper conductors
- Pass the requirements of ANSI C119.4
- Standard compression tools and dies install all sizes
- Seven Connector Program provides superior connector performance, lower connection costs and simplified installation procedures
- Fold-in tabs provide positive tab interlock as tool closes
- Field-proven ribbed design provides unparalleled connector/conductor contact, without distorting the conductor's shape
- Made of 1350 aluminum alloy
- Pre-filled with an oxide inhibitor which is held captive in the rib/connection area
- For copper to copper combinations, use CF type shown on page 45.

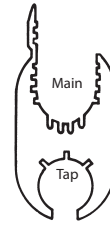

Fig. 1

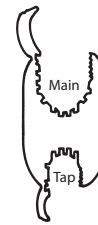
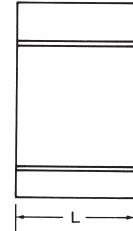

Fig. 2



Products on this page are not CSA Certified.

Cat. No.	Conductor Range													Connector Length L (in.)	Installation Information	
	Standard Conductor*					Compact Conductor				Diameter (in.)					For Use with Tool	No. of Indents
	Main		Tap			Main		Tap		Main		Tap				
	ACSR	Str.	ACSR	Str.	Sol.	ACSR	Str.	ACSR	Str.	max.	min.	max.	min.			
<b>WR699</b>	397-18/1 336 266		4 6	3 4 6	2 3 4 6			4 6	2 3 4 6	0.743	0.570	0.266	0.162	2	TBM12, JB12B and 13642M	2
<b>WR719</b>	397-18/1 336 266	400 397 350 336 300	2/0 1/0 1 2 3	2/0 1/0 1 2	3/0 2/0 1/0 1	477 397 350 336	477 397 350 336 300	2/0 1/0 1 2	3/0 2/0 1/0 1 2	0.743	0.570	0.447	0.289	2	TBM12, JB12B and 13642M	2
<b>WR739</b>	397-18/1 336 266	266 250	4/0 3/0 2/0 1/0	4/0 3/0 2/0	4/0			266 4/0 3/0	266 250 4/0	0.743	0.570	0.563	0.398	2	TBM12, JB12B and 13642M	2
<b>WR779</b>	397-18/1 336 266		397-18/1 336 266	400 397 350 336 266 250	477 397			477 397 336	477 397 336	0.743	0.570	0.743	0.570	3	TBM12, JB12B and 13642M	3
<b>WR799</b>	477-18/1 266	500 250	4 6	3 4 6	2 3 4 6	477-18/1 250	500 250	3 4 6	2 3 4 6	0.814	0.575	0.270	0.160	2	TBM12, JB12B and 13642M	2
<b>WR819</b>	477-18/1 397 336		2/0 1/0 1 2 3	2/0 1/0 1 2	3/0 2/0 1/0 1			2/0 1/0 1 2	3/0 2/0 1/0 1 2	0.858	0.659	0.477	0.289	2	TBM12, JB12B and 13642M	2
<b>WR839</b>	477-18/1 397 336	556 500 477 450 400 397 350 336	4/0 3/0 2/0	4/0 3/0	4/0	556 477 397	556 477 397	266 4/0 3/0	266 250 4/0	0.858	0.659	0.563	0.477	2	TBM12, JB12B and 13642M	2
<b>WR879**</b>	477-18/1 397 336		336-18/1 266	350 336 300 266	397			397 336	397 350 336	0.858	0.659	0.684	0.593	2	TBM12, JB12B and 13642M	3
<b>WR889</b>	477-18/1 397 336	500 400 397 350 336	477-18/1 397 336	500 400 397 350 336	-	556 477 397 336	556 477 397 350	556 477 397 336	556 477 397 350	0.814	0.666	0.814	0.666	2	TBM12, JB12B and 13642M	3

\*Will accept conductors of these same wire sizes with a 3% reduction of diameter (compressed).  
\*\*Not reversible (Fig. 2).

## Compression H-Taps Connectors

Compression Connectors

### Type WR — Wide Range Aluminum Tap Connectors “R” Die Seven Connector Program

- For combinations of aluminum-aluminum and aluminum-copper conductors
- Pass the requirements of ANSI C119.4
- Standard compression tools and dies install all sizes
- Seven Connector Program provides superior connector performance, lower connection costs and simplified installation procedures
- Fold-in tabs provide positive tab interlock as tool closes
- Field-proven ribbed design provides unparalleled connector/conductor contact, without distorting the conductor’s shape
- Made of 1350 aluminum alloy
- Pre-filled with an oxide inhibitor which is held captive in the rib/connection area
- For copper to copper combinations, use CF type shown on page 45.

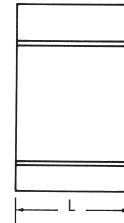
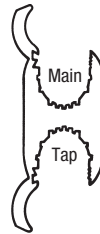

Products on this page are not CSA Certified.

Cat. No.	Conductor Range										Connector Length L (in.)	Installation Information				
	Standard Conductor				Compact Conductor				Diameter (in.)			For Use with Tool	Connector Die	No. of Indents		
	Main		Tap		Main		Tap		Main	Tap						
	ACSR	Str.	ACSR	Str.	ACSR	Str.	ACSR	Str.	max.	min.						
WR909	556-18/1	477	336-1/81	350	636	700	397-1/2	397	0.893	0.666	0.684	0.398	4-3/4	TBM15I (15620)	R	4
			266	336			336	350								
WR929	397	477	556-18/1	600	556	500	636	700	0.893	0.666	0.893	0.666	4-3/4	TBM15I (15620)	R	4
				450												
WR949	795-26/7	800	336-18/1	350	954	1000	636	700	1.108	0.883	0.684	0.398	4-3/4	TBM15I (15620)	R	4
				266												
WR969	666	795	556-18/1	600	874	795	954	363	1.108	0.883	0.893	0.666	4-3/4	TBM15I (15620)	R	4
				550												
WR989	606	715	795-26/7	900	954	1000	954	954	1.108	0.883	1.108	0.883	4-3/4	TBM15I (15620)	R	4
				874												
WR999	954-45/7	1033	954-45/7	1033	954	1000	954	1000	1.172	0.997	1.172	0.997	4-3/4	TBM15I (15620)	R	4
				900												

## Compression H-Taps Connectors

### Type WR — Street Lighting Compression Connectors

Compression Connectors

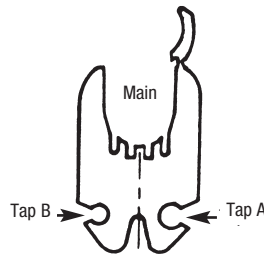

Fig. 1

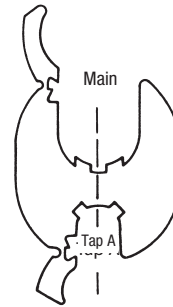
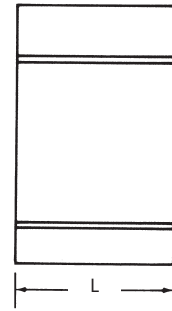

Fig. 2



Products on this page are not CSA Certified.

Cat. No.	Figure No.	Conductor Range														Connector Length L (in.)	Installation Information		
		Standard Conductor									Diameter (in.)						For Use with Tool	No. of Indents	
		Main			Tap A		Tap B		Main		Tap A		Tap B	Mech. Tool	Hyd. Tool				
		ACSR	Str.	Sol.	Str.	Sol.	Str.	Sol.	max.	min.	max.	min.	max.					min.	
<b>WR9**</b>	2	3 4 6	2 3 4 6	1 2 3 4	8 10 12 14	8 10 12 14	-	-	0.292	0.184	0.146	0.064	-	-	13/16	5/8 BG	3	-	
<b>WR139</b>	1	1/0 1 2 3 4	2/0 1/0 1 2 3	1 2	8 10	6 8 10	12 14 14	12 14	0.419	0.250	0.162	0.100	0.092	0.064	1-1/2	0	4	2	
<b>WR502</b>	1	4/0 3/0	4/0 3/0	-	8 10	6 8 10	12 14 14	12 14	0.563	0.461	0.162	0.100	0.092	0.064	1-1/2	D	4	-	
<b>WR502*</b>	1	4/0 3/0 2/0 1/0	4/0 3/0 2/0 1/0	-	8 10	6 8 10	12 14 14	12 14	0.563	0.365	0.162	0.100	0.092	0.064	1-1/2	D	-	2	

Will accept conductors of these same wire sizes with a 3% reduction of diameter (compressed).

\* This range possible only when crimped with hydraulic tool TBM14M or JB12B.

\*\* CSA Certified.

## Compression H-Taps Connectors

Compression Connectors

### Type CF — Copper Compression Tap Connectors

- For tapping copper conductors to unbroken main copper conductors
- Extruded pure electrolytic copper
- Full length tab for easy installation
- Efficient design for lower crimping force
- Standard compression tools and dies
- Single and double tab designs

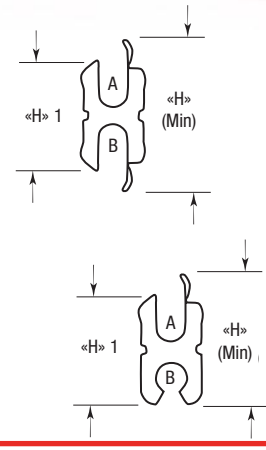
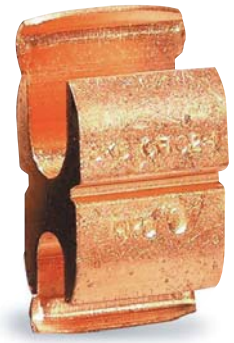

Cat. No.	Figure No.	Conductor Range								Dimensional Information			Installation Information						
		Standard Conductor				Diameter (in.)							Mechanical Tools***			Hydraulic Tools***			
		Main A		Tap B		Main A		Tap B		H (min.)	H 1	Connector Length (in.)	OD 58	Type 0	MD Series	JB12B	H Series	Y-35	TBM15/TBM15PF Y45/Y46
		ACSR	Str.	Sol.	Str.	max.	min.	max.	min.										
<b>CF44-1</b>	1	4 6	6	4 6 8	6	0.204	0.162	0.204	0.128	0.971	0.729	13/16	B, T 5/8	B, T 5/8	W-KB W-BG	BKT	B	BKT U-BG	BKT U-BG
<b>CFS44-1</b>	2	4 6	6	4 6 8	8	0.204	0.162	0.204	0.128	0.864	0.743	13/16	B, T 5/8	B, T 5/8	W-KB W-BG	BKT	BKT	BKT U-BG	BKT U-BG
<b>CF22-1</b>	1	2 4	4	2 4	4	0.258	0.204	0.258	0.204	1.162	0.813	13/16	K	K	W-KK	-			BKT
<b>CFS22-1</b>	2	2 4	4	2 6	6	0.258	0.204	0.258	0.162	1.017	0.842	13/16	K	K	W-KK	HBKC	BKT	BKT	BKT
<b>CF102-1</b>	1	-	1/0 1 2	2 4 6	4	0.373	0.292	0.258	0.162	1.540	1.100	27/32	-	-	-	0	0	0	0
<b>CF1010-1</b>	1	-	1/0 1 2	-	1/0 1 2	0.373	0.292	0.373	0.292	1.610	1.050	27/32	-	-	-	0	0	0	0
<b>CF202-1</b>	1	-	2/0 1/0	-	2/0 1/0 1 2	0.419	0.368	0.259	0.204	1.670	1.269	7/8	-	-	-	K-C	C	K-C	BK-C
<b>CF2020-1</b>	1	-	2/0 1/0	-	2/0 1/0 1 2	0.419	0.368	0.414	0.292	1.740	1.220	7/8	-	-	-	K-C	C	K-C	BK-C
<b>CF402-1</b>	1	-	4/0 3/0 2/0	2 4	4	0.528	0.414	0.259	0.204	1.983	1.423	1-1/8	-	-	-	D**	D**	D**	D**
<b>CF4010-1</b>	1	-	4/0 3/0 2/0	-	1/0 1 2	0.528	0.414	0.373	0.292	1.992	1.423	1-1/8	-	-	-	D**	D**	D**	D**
<b>CF4040-1</b>	1	-	4/0 3/0 2/0	-	4/0 3/0 2/0	0.528	0.414	0.528	0.414	2.252	1.483	1-1/8	-	-	-	D**	D**	D**	D**

\*Decimal dimensions are for conventional conductor, not Copperweld or Alumoweld.  
 \*\*Blackburn "D" dies.  
 \*\*\*Three indents with mechanical tools and one indent with hydraulic tools. 15-Ton/head use appropriate die adapters.

**Compression H-Taps Connectors**

**Type C — Compression Connectors Covers**

- Hinged polyethylene cover
- Installs easily, quickly—less expensive than taping
- Positive snap-locks fasten securely
- Drain ports prevent accumulation of corrosion-causing moisture
- Ultra-violet stabilized



C  
o  
m  
p  
r  
e  
s  
s  
i  
o  
n  
  
C  
o  
n  
n  
e  
c  
t  
o  
r  
s

Cat. No.	Capacity*	Dimensions (in.)		
		Height	Length	Width
<b>C2BB</b>	All 5/8" and O.D. Die taps, 2" long or less	1.10	4.00	1.05
<b>C5C</b>	All "O" Die taps, 1-3/4" long or less	1.60	3.75	1.25
<b>C7C</b>	All "D" Die taps, 2-1/2" long or less	1.80	5.00	1.45
<b>C9</b>	All "N" and "D" Die taps, up to 2" long	2.75	4.25	2.00
<b>C9L</b>	All "N" and "D" Die taps, up to 5" long	2.75	7.25	2.00

\* Before compression.

## Colour Coded Compression Connectors

Compression Connectors

### Type CTL — Copper Lugs, 1-Hole Mount, Short Barrel

#### Copper Compression Connectors

- For use with copper conductors: AWG stranded, flexible cable, welding cable and portable cord
- Specially designed for industrial and building applications
- Made of high conductivity seamless copper tubing
- Tin plated for corrosion resistance
- Specially chamfered barrel for ease of installation
- Colour coded for matching die identification
- Can be used for medium voltage application up to 35 kV provided proper insulation techniques are used
- CSA Certified and U.L. Listed for AWG conductors when installed with Blackburn, Burndy, T&B or Anderson tools, as specified by CSA
- Comply with Subpart 111.60-17 of Federal Register's Coast Guard Electrical Engineering Rules and Regulations

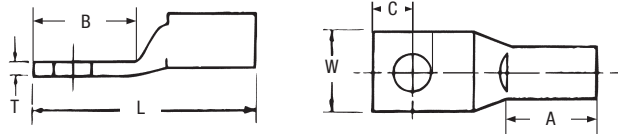

#### Short Barrel Connectors

- Short barrel connectors designed for regular duty applications
- Ideal for confined areas



Cat. No.	Conductor Size (CU)	Stud Size (in.)	Dimensions (in.)						Die Colour Code
			A	B	C	L	W	T	
CTL8-10	8 str.	10	13/32	1/2	7/32	1-5/32	3/8	1/16	Red
CTL8-14		1/4	13/32	19/32	1/4	1-3/16	7/16	1/16	
CTL8-516		5/16	13/32	5/8	9/32	1-5/16	9/16	1/16	
CTL6-10	6 str.	10	7/16	17/32	7/32	1-7/32	7/16	1/16	Blue
CTL6-14		1/4	7/16	17/32	7/32	1-7/32	7/16	1/16	
CTL6-516		5/16	7/16	21/32	9/32	1-13/32	19/32	1/16	
CTL6-38		3/8	7/16	21/32	9/32	1-13/32	19/32	1/16	
CTL4-10	4 str.	10	1/2	19/32	1/4	1-3/8	17/32	3/32	Grey
CTL4-14		1/4	1/2	19/32	1/4	1-3/8	17/32	3/32	
CTL4-516		5/16	1/2	21/32	5/16	1-13/32	19/32	1/16	
CTL4-38		3/8	1/2	21/32	5/16	1-13/32	19/32	1/16	
CTL2-14	2 + 3 str.	1/4	19/32	21/32	1/4	1-1/2	9/16	3/32	Brown
CTL2-516		5/16	19/32	7/8	3/8	1-23/32	9/16	3/32	
CTL2-38		3/8	19/32	29/32	3/8	1-3/4	9/16	3/32	
CTL2-12		1/2	19/32	1-1/16	1/2	1-29/32	3/4	1/16	
CTL1-14	1 str.	1/4	19/32	21/32	1/4	1-1/2	21/32	3/32	Green
CTL1-516		5/16	19/32	7/8	3/8	1-23/32	21/32	3/32	
CTL1-38		3/8	19/32	29/32	3/32	1-3/4	21/32	3/32	
CTL1-12		1/2	19/32	1-1/4	1/2	2-3/32	3/4	3/32	
CTL10-516	1/0 str.	5/16	11/16	7/8	3/8	1-13/16	3/4	1/8	Pink
CTL10-38		3/8	11/16	29/32	3/8	1-7/8	3/4	1/8	
CTL10-12		1/2	11/16	1-1/4	1/2	2-3/16	3/4	1/8	
CTL20-38	2/0 str.	3/8	13/16	29/32	3/8	2-1/32	13/16	1/8	Black
CTL20-12		1/2	13/16	1-1/4	1/2	2-11/32	13/16	1/8	
CTL30-38	3/0 str.	3/8	13/16	29/32	3/8	2-1/32	29/32	1/8	Orange
CTL30-12		1/2	13/16	1-1/4	1/2	2-11/32	29/32	1/8	
CTL40-38	4/0 str. or 3/0 weld	3/8	15/16	29/32	3/8	2-5/32	1-3/32	1/8	Purple
CTL40-12		1/2	15/16	1-1/4	1/2	2-1/2	1-1/32	1/8	
CTL250-12	250 kcmil or 4/0 weld	1/2	1-1/32	1-1/4	1/2	2-19/32	1-1/8	1/8	Yellow
CTL300-12	300 kcmil	1/2	1-1/32	1-1/4	1/2	2-25/32	1-3/16	5/32	White
CTL350-12	350 kcmil	1/2	1-1/32	1-1/4	1/2	2-25/32	1-11/32	5/32	Red
CTL400-12	400 kcmil	1/2	1-1/32	1-1/4	1/2	3-3/16	1-13/32	5/32	Blue
CTL400-58		5/8	1-1/32	1-9/16	5/8	3-1/2	1-13/32	5/32	
CTL500-12	500 kcmil	1/2	1-1/32	1-1/4	1/2	3-1/4	1-19/32	7/32	Brown
CTL500-58		5/8	1-1/32	1-9/16	5/8	3-9/16	1-19/32	7/32	
CTL600-58	600 kcmil	5/8	1-9/16	1-9/16	5/8	3-23/32	1-3/4	7/32	Green
CTL750-58	750 kcmil	5/8	1-1/2	1-9/16	5/8	3-25/32	1-29/32	1/4	Black
CTL1000-58	1000 kcmil	5/8	1-3/4	1-9/16	5/8	4-1/32	2-1/4	9/32	-

See pages 110-135 for more tool and die information.

## Colour Coded Compression Connectors

### Type CTL — Copper Lugs, 2-Hole Mount, Short Barrel

C o m p r e s s i o n  
C o n n e c t o r s

#### Copper Compression Connectors

- For use with copper conductors: AWG stranded, flexible cable, welding cable and portable cord
- Specially designed for industrial and building applications
- Made of high conductivity seamless copper tubing
- Tin plated for corrosion resistance
- Specially chamfered barrel for ease of installation
- Colour coded for matching die identification
- Can be used for medium voltage application up to 35 kV provided proper insulation techniques are used
- CSA Certified and U.L. Listed for AWG conductors when installed with Blackburn, Burndy, T&B or Anderson tools, as specified by CSA
- Comply with Subpart 111.60-17 of Federal Register's Coast Guard Electrical Engineering Rules and Regulations

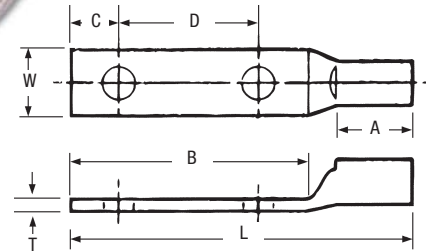
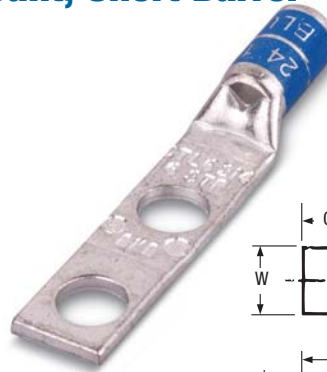

#### Short Barrel Connectors

- Short barrel connectors designed for regular duty applications
- Ideal for confined areas



Cat. No.	Conductor Size (CU)	Stud Size (in.)	Dimensions (in.)							Die Colour Code
			A	B	C	D	L	W	T	
CTL6-214	6 str.	1/4	1/2	1-1/4	1/4	5/8	1-31/32	13/32	1/16	Blue
CTL4-214	4 str.	1/4	1/2	1-1/4	1/4	5/8	2-1/32	1/2	3/32	Grey
CTL2-2516	2 + 3 str.	5/16	19/32	1-5/8	3/8	3/4	2-15/32	9/16	3/32	Brown
CTL1-2516	1 str.	5/16	19/32	1-3/4	3/8	7/8	2-19/32	21/32	3/32	Green
CTL10-2516	1/0 str.	5/16	11/16	1-3/4	3/8	7/8	2-11/16	3/4	1/8	Pink
CTL202	2/0 str.	1/2	13/16	2-13/16	1/2	1-3/4	3-13/16	13/16	1/8	Black
CTL302	3/0 str.	1/2	25/32	2-13/16	1/2	1-3/4	3-15/16	15/16	1/8	Orange
CTL402	4/0 str.	1/2	15/16	3	1/2	1-3/4	4-1/4	1-3/32	1/8	Purple
CTL2502	250 kcmil	1/2	1-1/32	3	1/2	1-3/4	4-11/32	1-1/8	5/32	Yellow
CTL3002	300 kcmil	1/2	1-1/32	3	1/2	1-3/4	4-17/32	1-3/16	5/32	White
CTL3502	350 kcmil	1/2	1-1/32	3	1/2	1-3/4	4-17/32	1-11/32	5/32	Red
CTL4002	400 kcmil	1/2	1-11/32	3	1/2	1-3/4	4-15/16	1-13/32	5/32	Blue
CTL5002	500 kcmil	1/2	1-3/8	3	1/2	1-3/4	5	1-17/32	7/32	Brown
CTL6002-38	600 kcmil	3/8	1-17/32	1-29/32	3/8	1-3/4	5-1/8	1-23/32	7/32	Green
CTL6002-12	600 kcmil	1/2	1-17/32	3	1/2	1-3/4	5-1/8	1-23/32	7/32	Green
CTL7502	750 kcmil	1/2	1-1/2	3	1/2	1-3/4	5-7/32	1-29/32	1/4	Black
CTL10002	1000 kcmil	1/2	1-3/4	3	1/2	1-3/4	5-7/16	2-1/4	9/32	-

See pages 110-135 for more tool and die information.

## Colour Coded Compression Connectors

Compression Connectors

### Type CTL — Copper Lugs, 1-Hole Mount, Long Barrel

#### Copper Compression Connectors

- For use with copper conductors: AWG stranded, flexible cable, welding cable and portable cord
- Specially designed for industrial and building applications
- Made of high conductivity seamless copper tubing
- Tin plated for corrosion resistance
- Specially chamfered barrel for ease of installation
- Colour coded for matching die identification
- Can be used for medium voltage application up to 35 kV provided proper insulation techniques are used
- CSA Certified and U.L. Listed for AWG conductors when installed with Blackburn, Burndy, T&B or Anderson tools, as specified by CSA
- Comply with Subpart 111.60-17 of Federal Register's Coast Guard Electrical Engineering Rules and Regulations

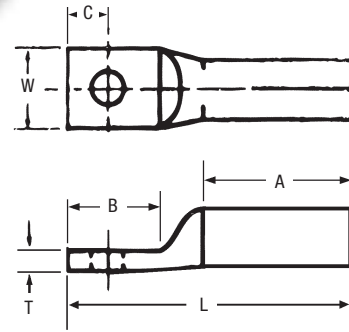

#### Long Barrel Connectors

- Ideal for industrial, oil rig, mining, welding and transportation electrical termination applications
- Heavy duty design which permits additional crimp for added - mechanical strength



Cat. No.	Conductor Size (CU)	Flexible Conductor Size	Stranded	Stud Size (in.)	Dimensions (in.)						Die Colour Code
					A	B	C	L	W	T	
<b>CTL8L-14</b>	8 str.	1/4	37/24	1/4	25/32	5/8	1/4	1-5/8	13/32	1/16	Red
<b>CTL6L-14</b>	6 str.	1/4	61/24	1/4	25/32	5/8	1/4	1-5/8	13/32	1/16	Blue
<b>CTL4L-14</b>	4 str.	5/16	91/24	1/4	25/32	5/8	1/4	1-11/16	1/2	3/32	Grey
<b>CTL2L-516</b>	2 + 3 str.	5/16	125/24	5/16	7/8	7/8	3/8	2-1/32	9/16	3/32	Brown
<b>CTL1L-516</b>	1 str.	5/16	150/24	5/16	1-3/32	7/8	3/8	2-5/32	21/32	3/32	Green
<b>CTL10L-516</b>	1/0 str.	1/2	225/24	5/16	1-3/32	7/8	3/8	2-7/32	3/4	1/8	Pink
<b>CTL20L-38</b>	2/0 str.	1/2	275/24	3/8	1-3/32	29/32	3/8	2-1/4	13/16	1/8	Black
<b>CTL30L-12</b>	3/0 str.	1/2	325/24	1/2	1-1/8	1-1/4	1/2	2-11/16	29/32	1/8	Orange
<b>CTL40L-12</b>	4/0 str.	1/2	-	1/2	1-3/8	1-1/4	1/2	2-15/16	1-1/32	1/8	Purple
<b>CTL250L-12</b>	250 kcmil	1/2	450/24	1/2	1-19/32	1-1/4	1/2	3-1/8	1-1/8	1/8	Yellow
<b>CTL300L-12</b>	300 kcmil	1/2	550/24	1/2	1-25/32	1-1/4	1/2	3-17/32	1-3/16	1/8	White
<b>CTL350L-12</b>	350 kcmil	1/2	650/24	1/2	1-27/32	1-1/4	5/8	3-19/32	1-11/32	5/32	Red
<b>CTL400L-58</b>	400 kcmil	1/2	775/24	5/8	1-27/32	1-9/16	5/8	4-1/32	1-13/32	5/32	Blue
<b>CTL500L-58</b>	500 kcmil	3/8	925/24	5/8	2-11/32	1-9/16	5/8	4-1/2	1-19/32	3/16	Brown
<b>CTL600L-58</b>	600 kcmil	1/2	1100/24	5/8	2-1/8	1-9/16	5/8	4-5/16	1-23/32	7/32	Green
<b>CTL750L-58</b>	750 kcmil	1/2	1325/24	5/8	2-3/8	1-9/16	5/8	4-21/32	1-29/32	1/4	Black
<b>CTL1000L-58</b>	1000 kcmil	1/2	1600/24 1925/24	5/8	2-7/8	1-9/16	5/8	5-5/32	2-1/4	9/32	-

See pages 110-135 for more tool and die information.

## Colour Coded Compression Connectors

### Type LCN — Copper Lugs, 2-Hole Mount, Long Barrel

C o m p r e s s i o n  
C o n n e c t o r s

#### Copper Compression Connectors

- For use with copper conductors: AWG stranded, flexible cable, welding cable and portable cord
- Specially designed for industrial and building applications
- Made of high conductivity seamless copper tubing
- Tin plated for corrosion resistance
- Specially chamfered barrel for ease of installation
- Colour coded for matching die identification
- Can be used for medium voltage application up to 35 kV provided proper insulation techniques are used
- CSA Certified and U.L. Listed for AWG conductors when installed with Blackburn, Burndy, T&B or Anderson tools, as specified by CSA
- Comply with Subpart 111.60-17 of Federal Register's Coast Guard Electrical Engineering Rules and Regulations



#### Long Barrel Connectors

- Ideal for industrial, oil rig, mining, welding and transportation electrical termination applications
- Heavy duty design which permits additional crimp for added mechanical strength



Cat. No.	Conductor Size (CU)	Flexible Conductor Size	Stranded	Stud Size (in.)	Dimensions (in.)							Die Colour Code
					A	B	C	D	L	W	T	
LCN8-14	8 str.	8	37/24	1/4	25/32	1-3/16	1/4	5/8	2-1/8	15/32	1/16	Red
LCN6-14	6 str.	6	61/24	1/4	25/32	1-1/4	1/4	5/8	1-1/4	13/32	1/16	Blue
LCN6-12	6 str.	6	61/24	1/2	25/32	3	1/2	1-3/4	4-5/32	7/8	3/32	Blue
LCN4-14	4 str.	5	91/24	1/4	25/32	1-3/16	1/4	5/8	2-3/16	17/32	3/16	Grey
LCN4-12	4 str.	5	91/24	1/2	25/32	3	1/2	1-3/4	4-5/32	7/8	3/32	Grey
LCN2-516	2 + 3 str.	3	125//24	5/16	7/8	1-5/8	3/8	3/4	2-15/16	9/16	3/32	Brown
LCN2-12	2 str.	3	125/24	1/2	7/8	3	1/2	1-3/4	4-1/4	7/8	3/32	Brown
LCN1-516	1 str.	2	150/24	5/16	1-1/32	1-5/8	3/8	7/8	2-31/32	21/32	3/32	Green
LCN1-12	1 str.	2	150/24	1/2	1-1/32	3	1/2	1-3/4	4-13/32	7/8	3/32	Green
LCN10	1/0 str.	1	225/24	1/2	1-1/32	3	1/2	1-3/4	3-31/32	3/4	1/8	Pink
LCN20	2/0 str.	1/0	275/24	1/2	1-5/16	3	1/2	1-3/4	4-3/16	13/16	1/8	Black
LCN30	3/0 str.	2/0	325/24	1/2	1-1/8	2-15/16	1/2	1-3/4	4-7/16	15/16	1/8	Orange
LCN40	4/0 str.	—	—	1/2	1-3/8	3	1/2	1-3/4	4-11/16	1-11/32	1/8	Purple
LCN250	250 kcmil	3/0	450/24	1/2	1-19/32	3	1/2	1-3/4	4-29/32	1-1/16	1/8	Yellow
LCN300	300 kcmil	4/0	550/24	1/2	1-25/32	3	1/2	1-3/4	5-9/32	1-3/16	1/8	White
LCN350	350 kcmil	263	650/24	1/2	1-27/32	3	1/2	1-3/4	5-11/32	1-11/32	5/32	Red
LCN400	400 kcmil	313	775/24	1/2	1-27/32	3	1/2	1-3/4	5-7/16	1-13/32	5/32	Blue
LCN500	500 kcmil	373	925/24	1/2	2-11/32	3	1/2	1-3/4	5-15/16	1-19/32	3/16	Brown
LCN600	600 kcmil	444	1100/24	1/2	2-1/8	3	1/2	1-3/4	5-3/4	1-23/32	7/32	Green
LCN75	750 kcmil	535	1325/24	1/2	2-3/8	3	1/2	1-3/4	6-3/32	1-29/32	1/4	Black
LCN99	1000 kcmil	646 777	1600/24 1925/24	1/2	2-7/8	3	1/2	1-3/4	6-19/32	2-1/4	9/32	—

See pages 110-135 for more tool and die information.

## Colour Coded Compression Connectors

### Type CSP — Copper Splices, Short Barrel

#### Copper Compression Connectors

- For use with copper conductors: AWG stranded, flexible cable, welding cable and portable cord
- Specially designed for industrial and building applications
- Made of high conductivity seamless copper tubing
- Tin plated for corrosion resistance
- Specially chamfered barrel for ease of installation
- Colour coded for matching die identification
- Can be used for medium voltage application up to 35 kV provided proper insulation techniques are used
- CSA Certified and U.L. Listed for AWG conductors when installed with Blackburn, Burndy, T&B or Anderson tools, as specified by CSA
- Comply with Subpart 111.60-17 of Federal Register's Coast Guard Electrical Engineering Rules and Regulations

#### Short Barrel Connectors

- Short barrel connectors designed for regular duty applications
- Ideal for confined areas



Cat. No.	Conductor Size (CU)	Length L (in.)	Die Colour Code
CSP8	8 str.	1	Red
CSP6	6 str.	1	Blue
CSP4	4 str.	1	Gray
CSP2	2 + 3 str.	1-1/4	Brown
CSP1	1 str.	1-1/2	Green
CSP10	1/0 str.	1-5/8	Pink
CSP20	2/0 str.	1-3/4	Black
CSP30	3/0 str.	1-3/4	Orange
CSP40	4/0 str.	1-7/8	Purple
CSP250	250 kcmil	2-1/4	Yellow
CSP300	300 kcmil	1-1/8	White
CSP350	350 kcmil	2-1/4	Red
CSP400	400 kcmil	2-3/4	Blue
CSP500	500 kcmil	2-3/4	Brown
CSP600	600 kcmil	3	Green
CSP750	750 kcmil	3	Black
CSP1000	1000 kcmil	3-5/8	-

See pages 110–135 for more tool and die information.

## Colour Coded Compression Connectors

### Type CU — Copper Splices, Long Barrel

C o m p r e s s i o n  
C o n n e c t o r s

#### Copper Compression Connectors

- For use with copper conductors: AWG stranded, flexible cable, welding cable and portable cord
- Specially designed for industrial and building applications
- Made of high conductivity seamless copper tubing
- Tin plated for corrosion resistance
- Specially chamfered barrel for ease of installation
- Colour coded for matching die identification
- Can be used for medium voltage application up to 35 kV provided proper insulation techniques are used
- CSA Certified and U.L. Listed for AWG conductors when installed with Blackburn, Burndy, T&B or Anderson tools, as specified by CSA
- Comply with Subpart 111.60-17 of Federal Register's Coast Guard Electrical Engineering Rules and Regulations



#### Long Barrel Connectors

- Ideal for industrial, oil rig, mining, welding and transportation electrical termination applications
- Heavy duty design which permits additional crimp for added mechanical strength

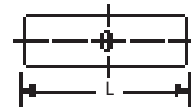

Cat. No.	Conductor Size (CU)	Flexible Conductor		Stud Size (in.)	Length L (in.)	Die Colour Code
		CMA	Stranded			
CU8	8 str.	8	37/24	1/4	1-3/4	Red
CU6	6 str.	6	61/24	1/4	1-3/4	Blue
CU4	4 str.	5	91/24	1/4	1-3/4	Grey
CU2	2 + 3 str.	3	125/24	5/16	1-7/8	Brown
CU1	1 str.	2	150/24	5/16	2	Green
CU10	1/0 str.	1	225/24	5/16	2	Pink
CU20	2/0 str.	1/2	275/24	3/8	2-1/8	Black
CU30	3/0 str.	2/0	325/24	1/2	2-1/4	Orange
CU40	4/0 str.	—	—	1/2	2-3/4	Purple
CU250	250 kcmil	3/0	450/24	1/2	3-3/8	Yellow
CU300	300 kcmil	4/0	550/24	1/2	3-1/2	White
CU350	350 kcmil	263	650/24	1/2	3-3/4	Red
CU400	400 kcmil	313	775/24	5/8	3-3/4	Blue
CU500	500 kcmil	373	925/24	5/8	4-3/4	Brown
CU600	600 kcmil	444	1100/24	5/8	4-1/4	Green
CU750	750 kcmil	535	1325/24	5/8	4-3/4	Black
CU1000	1000 kcmil	646 777	1600/24 1925/24	5/8	5-5/8	—

See pages 110–135 for more tool and die information.

## Colour Coded Compression Connectors

Compression Connectors

### Type ATL — Aluminum Lugs, 1-Hole

#### Aluminum Compression Connectors

- Specifically designed for use with aluminum conductors (concentric, compressed or compact)
- Also listed for use with copper conductors
- Made of high conductivity seamless aluminum tubing
- Tin plated for corrosion resistance
- Chamfered barrels for ease of installation
- Can be used for medium voltage applications up to 35 kV provided proper insulation techniques are used
- CSA Certified and U.L. Listed for AWG conductors when installed with Blackburn, Burndy, T&B or Anderson tools, as specified by CSA
- Colour coded for quick, easy die identification
- Pre-filled with oxide inhibiting compound

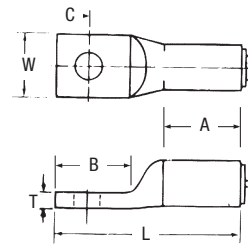

Cat. No.	Conductor Size		Stud Size (in.)	Dimensions (in.)						Die Colour Code
	(AL)	(CU)		A	B	C	L	W	T	
ATL8-10	8 str.	6 AWG	10	1/2	19/32	7/32	1-9/32	13/32	3/32	Blue
ATL8-14	8 str.	6 AWG	1/4	1/2	11/16	11/32	1-3/8	7/16	3/32	Blue
ATL6-10	6 str.	4 AWG	10	25/32	9/16	7/32	1-1/2	15/32	1/8	Grey
ATL6-14	6 str.	4 AWG	1/4	25/32	23/32	15/32	1-21/32	15/32	1/8	Grey
ATL6-38	6 str.	4 AWG	3/8	27/32	29/32	7/16	1-27/32	5/8	3/32	Grey
ATL4-14	4 str.	1 AWG	1/4	27/32	13/16	11/32	1-29/32	5/8	3/16	Green
ATL4-516	4 str.	1 AWG	5/16	27/32	1	7/16	2-1/16	5/8	3/16	Green
ATL4-38	4 str.	1 AWG	3/8	27/32	29/32	7/16	2	5/8	3/16	Green
ATL2-14	2 + 3 str.	1/0 AWG	1/4	27/32	25/32	11/32	1-15/16	23/32	3/16	Pink
ATL2-516	2 + 3 str.	1/0 AWG	5/16	27/32	7/8	7/16	2-11/32	3/4	3/16	Pink
ATL2-38	2 + 3 str.	1/0 AWG	3/5	27/32	29/32	7/16	2-1/16	23/32	3/16	Pink
ATL1-516	1 str.	-	5/16	27/32	7/8	7/16	2-1/32	23/32	3/16	Gold
ATL1-38	1 str.	-	3/8	27/32	29/32	7/16	2-3/8	3/4	3/16	Gold
ATL10-516	1/0 str.	-	5/16	1-5/32	1	7/16	2-17/32	7/8	3/16	Tan
ATL10-38	1/0 str.	-	3/8	1-5/32	1-1/16	7/16	2-19/32	7/8	3/16	Tan
ATL10-12	1/0 str.	-	1/2	1-5/32	1-3/8	11/16	2-15/16	15/16	3/16	Tan
ATL20-38	2/0 str.	-	3/8	1-3/16	1	7/16	2-5/8	31/32	7/32	Olive
ATL20-12	2/0 str.	-	1/2	1-3/16	1-3/8	11/16	3	1-1/32	7/32	Olive
ATL30-38	3/0 str.	-	3/8	1-11/32	1-1/16	7/16	2-13/16	1-1/16	7/32	Ruby
ATL30-12	3/0 str.	-	1/5	1-11/32	1-3/8	11/16	3-1/8	1-1/16	7/32	Ruby
ATL40-38	4/0 str.	300 kcmil	3/8	1-7/8	1-3/32	3/8	3-3/4	1-3/16	1/4	White
ATL40-12	4/0 str.	300 kcmil	1/2	1-7/8	1-1/4	1/2	3-7/8	1-3/16	1/4	White
ATL250-12	250 kcmil	350 kcmil	1/5	2-1/32	1-1/4	1/2	4-1/32	1-9/32	1/4	Red
ATL300-38	300 kcmil	400 kcmil	3/8	2	1-5/16	3/8	4-3/16	1-3/8	9/32	Blue
ATL300-12	300 kcmil	400 kcmil	1/2	2	1-5/16	1/2	4-3/16	1-3/8	9/32	Blue
ATL350-12	350 kcmil	500 kcmil	1/2	2-11/16	1-5/16	1/2	4-7/8	1-1/2	5/16	Brown
ATL400-58	400 kcmil	600 kcmil	5/8	2-11/16	1-1/4	1/2	4-15/16	1-5/8	3/8	Green
ATL500-12	500 kcmil	700 kcmil	1/2	2-11/16	1-1/4	1/2	4-15/16	1-25/32	3/8	Pink
ATL500-58	500 kcmil	700 kcmil	5/8	2-11/16	2	3/4	5-11/16	1-25/32	3/8	Pink
ATL600-12	-	600 kcmil	1/2	2-11/16	2	3/4	5-13/16	1-29/32	11/32	Black
ATL750-12	750 kcmil	900 kcmil	1/2	2-7/8	1-1/4	1/2	5-1/4	2-1/8	3/8	-
ATL750-58	750 kcmil	900 kcmil	5/8	2-7/8	2	3/4	6-1/32	2-1/8	3/8	-

See pages 110-135 for more tool and die information.

## Colour Coded Compression Connectors

Compression Connectors

### Type ATL — Aluminum Lugs, 2-Hole

#### Aluminum Compression Connectors

- Specifically designed for use with aluminum conductors (concentric, compressed or compact)
- Also listed for use with copper conductors
- Made of high conductivity seamless aluminum tubing
- Tin plated for corrosion resistance
- Chamfered barrels for ease of installation
- Can be used for medium voltage applications up to 35 kV provided proper insulation techniques are used
- Colour coded for quick, easy die identification
- Pre-filled with oxide inhibiting compound
- CSA Certified and U.L. Listed for AWG conductors when installed with Blackburn, Burndy, T&B or Anderson tools, as specified by CSA

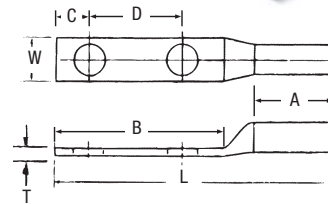

Cat. No.	Conductor Size		Stud Size (in.)	Dimensions (in.)							Die Colour Code
	(AL)	(CU)		A	B	C	D	L	W	T	
<b>ATL102-38</b>	1/0 str.	—	3/8	1-5/32	2-1/16	3/8	1	3-19/32	7/8	3/16	Tan
<b>ATL102</b>	1/0 str.	—	1/2	1-3/16	3	1/2	1-3/4	4-9/16	15/16	3/16	Tan
<b>ATL202</b>	2/0 str.	—	1/2	1-3/16	3-3/8	3/4	1-3/4	5	31/32	7/32	Olive
<b>ATL302</b>	3/0 str.	—	1/2	1-11/32	3-3/8	3/4	1-3/4	5-5/32	1-1/16	7/32	Ruby
<b>ATL402</b>	4/0 str.	300 kcmil	1/2	1-7/8	3	1/2	1-3/4	5-5/8	1-3/16	1/4	White
<b>ATL2502</b>	250 kcmil	350 kcmil	1/2	2-1/32	3	1/2	1-3/4	5-25/32	1-9/32	1/4	Red
<b>ATL3002</b>	300 kcmil	400 kcmil	1/2	2	3	1/2	1-3/4	5-7/8	1-3/8	9/32	Blue
<b>ATL3502</b>	350 kcmil	500 kcmil	1/2	2-11/16	3	1/2	1-3/4	6-9/16	1-1/2	5/16	Brown
<b>ATL4002</b>	400 kcmil	600 kcmil	1/2	2-11/16	3	1/2	1-3/4	6-11/16	1-5/8	3/8	Green
<b>ATL5002</b>	500 kcmil	700 kcmil	1/2	2-11/16	3	1/2	1-3/4	6-11/16	1-25/32	3/8	Pink
<b>ATL6002</b>	—	600 kcmil	1/2	2-11/16	3	1/2	1-3/4	6-13/16	1-29/32	11/32	Black
<b>ATL7502</b>	750 kcmil	900 kcmil	1/2	2-7/8	3	1/2	1-3/4	7-1/8	2-1/8	3/8	—

See pages 110-135 for more tool and die information.

## Colour Coded Compression Connectors

Compression Connectors

### Type ASP — Aluminum Splices

#### Aluminum Compression Connectors

- Specifically designed for use with aluminum conductors (concentric, compressed or compact)
- Also listed for use with copper conductors
- Made of high conductivity seamless aluminum tubing
- Tin plated for corrosion resistance
- Chamfered barrels for ease of installation
- Can be used for medium voltage applications up to 35 kV provided proper insulation techniques are used
- Colour coded for quick, easy die identification
- Pre-filled with oxide inhibiting compound
- CSA Certified and U.L. Listed when installed with Blackburn, Burndy, T&B or Anderson tools, as specified by CSA



Cat. No.	Conductor Size		Length L (in.)	Die Colour Code
	(AL)	(CU)		
ASP8	8 str.	6 AWG	1-1/4	Blue
ASP6	6 str.	4 AWG	1-5/8	Grey
ASP4	4 str.	1 AWG	1-7/8	Green
ASP2	2 + 3 str.	1/0 AWG	1-7/8	Pink
ASP1	1 str.	–	2-3/8	Gold
ASP10	1/0 str.	–	2-3/8	Tan
ASP20	2/0 str.	–	2-1/2	Olive
ASP30	3/0 str.	–	2-7/8	Ruby
ASP40	4/0 str.	300 kcmil	3-3/4	White
ASP250	250 kcmil	350 kcmil	4	Red
ASP300	300 kcmil	400 kcmil	4	Blue
ASP350	350 kcmil	500 kcmil	3-7/8	Brown
ASP400	400 kcmil	600 kcmil	4-7/8	Green
ASP500	500 kcmil	700 kcmil	5	Pink
ASP600	–	600 kcmil	5-1/8	Black
ASP750	750 kcmil	900 kcmil	5-3/8	–
ASP1000	1000 kcmil	–	6	–

See pages 110–135 for more tool and die information.

## Colour Coded Compression Connectors

Compression Connectors

### Type PA — Pin Adapter Terminals

- Connector for aluminum conductors only; pigtail may be inserted into either aluminum or copper connectors
- Insulating cover included
- 90°C Rating per U.L. 486B
- Tin plated stranded copper wire pigtail
- Tin plated aluminum barrel pre-filled with oxide inhibitor and capped

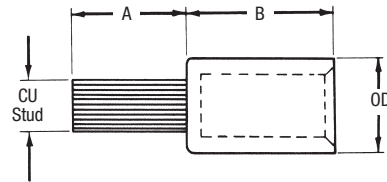
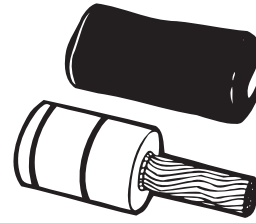

Cat. No.	Conductor Size (CU)	Copper Stud Size	Dimensions (in.)			Die Colour Code	Die #
			A	B	O.D.		
PA06	6 str.	8	7/8	1-11/32	0.640	Orange	50
PA04	4 str.	6	7/8	1-11/32	0.640	Orange	50
PA02	2 str.	4	7/8	1-11/32	0.640	Orange	50
PA01	1 str.	3	1	1-11/32	0.640	Orange	50
PA11	1/0 str.	2	1-1/4	1-19/32	0.906	Red	76
PA21	2/0 str.	1	1-1/4	1-19/32	0.906	Red	76
PA31	3/0 str.	1/0	1-3/8	1-7/8	0.906	Red	76
PA41	4/0 str.	2/0	1-3/8	1-7/8	0.906	Red	76
PA25	250 kcmil	3/0	1-1/2	2-1/16	1.155	Brown	87H
PA30	300 kcmil	4/0	1-5/8	2-1/16	1.155	Brown	87H
PA35	350 kcmil	4/0	1-5/8	2-1/16	1.155	Brown	87H
PA40	400 kcmil	250 kcmil	1-7/8	2-3/32	1.375	Pink	106H
PA50	500 kcmil	350 kcmil	1-7/8	2-3/32	1.375	Pink	106H
PA60	600 kcmil	350 kcmil	1-7/8	2-3/4	1.500	Yellow	115H
PA75	750 kcmil	500 kcmil	2	2-3/4	1.500	Yellow	115H

U.L. Listed AL9CU.  
Products on this page are not CSA Certified.

T&B Dies									
Alum. Wire Size	Die Code	UT3	UT5	TBM5	TBM6	TBM8	13642 12-Ton	TBM15 UT15	21920 20-Ton
#6 – #1	50	5/8	TU	Orange	–	–	–	15529	–
1/0 – 4/0	76 or 76H	–	TX	–	13472 Red 13476 Red	13467	11744	15512	11170
250 kcmil – 350 kcmil	87H	–	TH	–	–	13468	11746	15506	11176
400 kcmil – 500 kcmil	106H	–	–	–	–	–	11749	15515	11140
600 kcmil – 750 kcmil	115H	–	–	–	–	–	11753	15504	11157

## Service Wedge Clamps

### Type W — Stainless Steel Wedge Clamps

- For use on copper neutral
- Stainless Steel wedge and slider

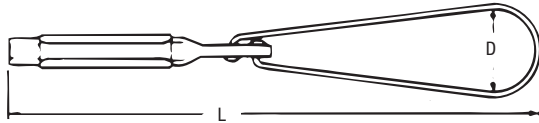

Cat. No.	Conductor Range			Dimensions (in.)		Typical Tensile Values	
	ACSR	AL	AAAC	D	L	Conductor	Value (lb.)
<b>W62D</b>	2-6	1 str. - 6 sol.	2-6	2-3/8 flex.	12	2 6 x 1 ACSR	1200

### Type W — Aluminum Service Wedge Clamps for use with ACSR, Aluminum, AAAC Conductors

- For dead-ending self-supporting drop wire
- Saves conductor—drop wire may be cut to exact length
- Can be attached to bare neutral at any point in the span
- Adjustments in drop wire sag are easily made
- Grips ACSR, AAAC, or aluminum conductors

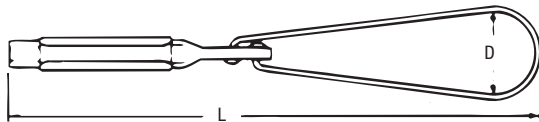

Cat. No.	Description	Conductor Range			Dimensions (in.)		Typical Tensile Values	
		ACSR	AL	AAAC	D	L	Conductor	Value (lb.)
<b>W62-1</b>	W-1 Series Aluminum Wedge and Slider	2-6	1 str. - 6 sol.	2-6	2-3/8 flex.	12, 17-1/2	2 6 x 1 ACSR	1200
<b>W62-1FC</b>	W-1 Series Aluminum Wedge and Slider	2-6	1 str. - 6 sol.	2-6	2-3/8 flex.	12, 17-1/2	2 6 x 1 ACSR	1200
<b>W20-1</b>	W-1 Series Aluminum Wedge and Slider	1/0-4	2/0 str. - 2 sol.	1/0-4	2-3/8 flex.	12-1/2, 18-1/2	1/0 6 x 1 ACSR	1800
<b>W20-1FC</b>	W-1 Series Aluminum Wedge and Slider	1/0-4	2/0 str. - 2 sol.	1/0-4	2-3/8 flex.	12-1/2, 18-1/2	1/0 6 x 1 ACSR	1800
<b>W40-1*</b>	W-1 Series Aluminum Wedge and Slider	4/0-2/0	4/0 str. - 2 sol.	4/0-2/0	2-3/8 flex.	12-3/4, 18-1/2	4/0 6 x 1 ACSR	1900
<b>W40-1FC*</b>	W-1 Series Aluminum Wedge and Slider	4/0-2/0	4/0 str. - 2 sol.	4/0-2/0	2-3/8 flex.	12-3/4, 18-1/2	4/0 6 x 1 ACSR	1900
<b>W62-1B</b>	W-1B Series for extremely corrosive areas. Iridited Aluminum Wedge and Slider	2-6	1 str. - 6 sol.	2-6	2-3/8 flex.	12, 17-1/2	2 6 x 1 ACSR	1200
<b>W62-1BFC</b>	W-1B Series for extremely corrosive areas. Iridited Aluminum Wedge and Slider	2-6	1 str. - 6 sol.	2-6	2-3/8 flex.	12, 17-1/2	2 6 x 1 ACSR	1200
<b>W20-1B</b>	W-1B Series for extremely corrosive areas. Iridited Aluminum Wedge and Slider	1/0-4	2/0 str. - 2 sol.	1/0-4	2-3/8 flex.	12-1/2, 18-1/2	1/0 6 x 1 ACSR	1800
<b>W20-1BFC</b>	W-1B Series for extremely corrosive areas. Iridited Aluminum Wedge and Slider	1/0-4	2/0 str. - 2 sol.	1/0-4	2-3/8 flex.	12-1/2, 18-1/2	1/0 6 x 1 ACSR	1800
<b>W40-1B*</b>	W-1B Series for extremely corrosive areas. Iridited Aluminum Wedge and Slider	4/0-2/0	4/0 str. - 2 sol.	4/0-2/0	2-3/8 flex.	12-3/4, 18-1/2	4/0 6 x 1 ACSR	1900
<b>W40-1BFC*</b>	W-1B Series for extremely corrosive areas. Iridited Aluminum Wedge and Slider	4/0-2/0	4/0 str. - 2 sol.	4/0-2/0	2-3/8 flex.	12-3/4, 18-1/2	4/0 6 x 1 ACSR	1900

\* W40 series clamps rated 850 lb ultimate tension for 1/0 ACSR, AL, or AAAC.