

**Technical Specifications**

T&B's While-In-Use covers keep out moisture and take the hassle and cost out of installation. Single or two-gang kits accommodate various configurations, and some covers are designed with a method to secure using an external locking device. Perfect for all outdoor outlets including landscape lighting, lawn equipment, pool/hot tub pumps, and holiday lighting.

Applications:

- Protects receptacles and switches for single and two gang configurations in dry and wet locations.
- Prevents accidental equipment disconnects.
- Deters theft and equipment removal (when locked).

Features/Benefits:

- Supplied in kit form covering most installation requirements.
- Horizontal or vertical orientation.
- Lockable cover design for added security.
- High impact UV-resistant polycarbonate base construction.
- Weatherproof, thermoplastic base configuration.
- Accommodates most commonly used receptacles and switches.
- Mounts to box or to device (all installation screws included).
- Device holes are keyed for easy installation in retrofit applications.
- Non-metallic, flame retardant.

Standard Materials as noted:

- Bases: polycarbonate.
- Covers: thermoplastic or polycarbonate.

Compliances:

Compliances as noted on each page of the catalogue include:

- CSA Certified
- UL Listed
- C-UL Listed

Weatherproof Non-Metallic Covers While-In-Use



CKNM

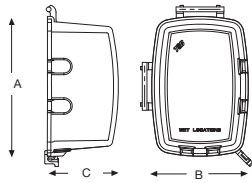

2CKNM

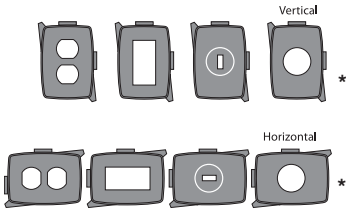
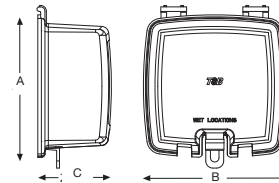

*1-19/32 diameter fits up to 30A twist lock receptacle.

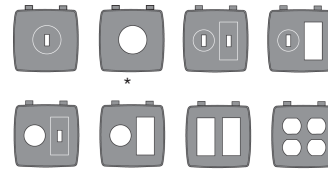

*2-1/8 diameter
**1-19/32 diameter

Cat. No.	Description	A	B	C
Universal While-In-Use Covers (Non-Metallic)				
CKNM*	Single Gang accommodates Duplex, GFCI, switch, single 1-19/32 horizontal or vertical receptacles – lockable	5-1/2	2-3/4	4
2CKNM*	Two Gang accommodates Duplex, GFCI, switch, single 1-19/32 or 2-1/8 horizontal or vertical receptacles – lockable	5	2-3/8	5



CKRU-8

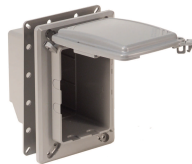

CKRU-G8

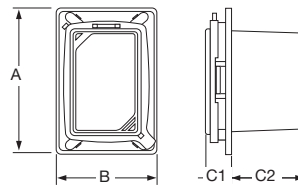

Inserts

Cat. No.	Description	A	B	C1	C2
Universal Recessed Bodies (Non-Metallic)					
CKRU-G8*	Grey body with grey cover. Accommodates GFCI, Duplex, toggle switch and single 1-9/16 receptacle - lockable.	7-1/4	5	1-1/2	3-9/16
CKRU-WH8*	White body with white cover. Accommodates GFCI, Duplex, toggle switch and single 1-9/16 receptacle - lockable.				
CKRU-8*	Grey body with clear cover. Accommodates GFCI/Duplex, toggle switch and single 1-9/16 receptacle - lockable.				

*Locking Device not included.

Dimensions are in inches.
Covers packed with device plates, gasket and screws.





E9UVCRN2

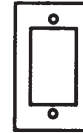
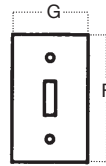
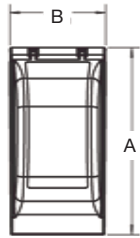

Inserts

Cat. No.	Description	Color	A	B	D	F	G
Vertical Mount – Standard Covers – 2-41/64" Deep (Non-Metallic)							
E9UVGRN2*	Accommodates Toggle, Duplex or GFCI receptacles	Grey	6-1/2	3-25/64	2-21/64	4-3/32	2-9/32
E9UVWRN2*		White					
E9UVCRN2*		Clear					



E9UHGRN2

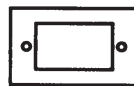
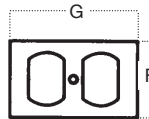
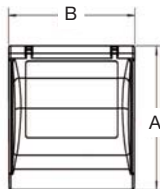

Inserts

Cat. No.	Description	Color	A	B	D	F	G
Horizontal Mount – Standard Covers – 2-17/32" Deep (Non-Metallic)							
E9UHGRN2*	Accommodates GFCI or Duplex receptacles	Grey	4-3/4	5-7/32	2-17/32	2-9/32	4-3/32
E9UHWRN2*		White					
E9UHCRN2*		Clear					

* Lockable: drill a 7/32 hole on cover lug.



Weatherproof Non-Metallic Covers While-In-Use

Carlton®

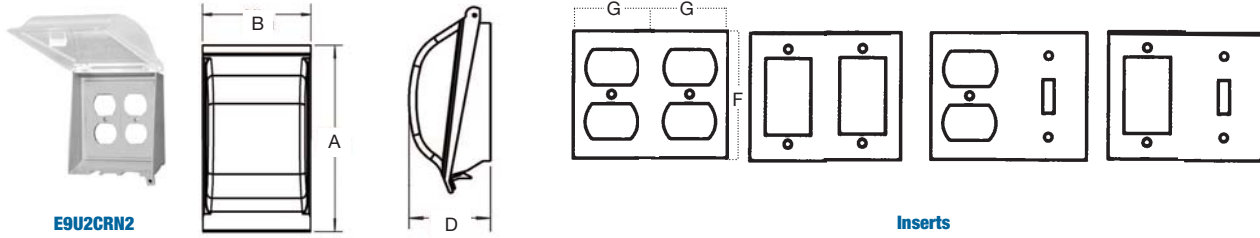

Cat. No.	Description	Color	A	B	D	F	G
Double Gang - Standard Covers - 2-21/64" Deep (Non-Metallic)							
E9U2GRN2*	Accommodates double Duplex, double GFCI, combination Duplex and Toggle or combination GFCI and Toggle receptacles	Grey	6-1/2	5-7/32	2-21/64	4-7/64	2-3/64
E9U2WRN2*		White					
E9U2CRN2*		Clear					

* Lockable: drill a 7/32 hole on cover lug.



Dimensions are in inches.
Covers packed with device plates, gasket and screws.

Thomas & Betts