



LDX-TS SERIES

T-Bar 12V MR16 LED Unit

new product



Type:	_____
Project/Location:	_____
Contractor:	_____
Prepared By:	_____
Date:	_____
Model No.:	_____

TYPICAL SPECIFICATIONS

Supply and install a complete emergency lighting system as described herein and shown on the drawings. The **Ready-Lite®** Smart Diagnostic Micro controller board shall supply the rated load for a minimum of a 30 minutes to 87.5% of the rated battery voltage. The unit shall be rated 120V or 347V, 60 Hz and be CSA listed. The unit shall have an output of V. The charger shall be fully computer tested and its charge voltage factory set to ± 1% tolerance. Chargers with field-adjusted potentiometers are not acceptable. A pulse-type charger shall be employed to promote long battery life and reduce the potential for grid corrosion.

The charger shall provide a continuous high charge to recharge the battery, when the battery is at full capacity, the charger will shut-off. Periodically the charger shall provide a pulse of energy to keep the battery topped off. The charger shall be current limited, temperature compensated, short-circuit proof and reverse polarity protected. The unit shall be furnished with an electronic lockout circuit, which will connect the battery when the AC circuit is activated, and an electronic brownout circuit, which will activate the emergency lights when utility power dips below 75% of nominal voltage. A low voltage battery protection circuit shall be provided and will disconnect the battery from the fused output circuit at the end of discharge. The unit shall self-test for 1 minute every 30 days, 10 minutes on the 6th month and 30 minutes every 12 months.

The unit shall be capable of full recharge in compliance with CSA specifications. The unit shall be furnished with sealed dust tight relay, a test switch and seven diagnostic LED indicator lights to continuously monitor the status of the unit: Battery Failure, Battery Disconnected, Charger Failure, Lamp Failure, Service Alarm, AC "ON", Charger High Rate. The unit shall be T-bar mounted and come complete with tool-less emergency lighting heads requiring no tools to adjust or aim.

The unit shall be **Ready-Lite®** model: _____ .

REPLACEMENT LAMPS

ORDERING CODE	LAMP TYPE	VOLTAGE/WATTAGE
580.0093-RL	MR16, LED	12V-4W
580.0104-RL	MR16, LED	12V-5W
580.0106-RL	MR16, LED	12V-6W

POWER CONSUMPTION AND UNIT RATING

MODEL	AC SPECS		WATTAGE CAPACITY				
			30MIN	1H00	1H30	2H00	4H00
LDX12-36TS	120/347VAC	0.09/0.03A	36	21	15	12	-
LDX12-72TS		0.15/0.06A	72	42	30	24	12

FULLY RECESSED UNITS FOR T-BAR MOUNTING IN SUSPENDED CEILINGS.

The **LDX-TS Series** battery units are designed for T-bar ceiling grid installation. This slim-line, unobtrusive unit is ideally suited for any commercial location where there is limited wall space and where the greater directional flexibility of ceiling-mounted heads is needed to provide greater light distribution.

FEATURES

- Rugged steel cabinet with corrosion-resistant undercoating
- Battery and charger are concealed above the ceiling level in the unit cabinet
- Removable panel provides easy access to battery and circuitry
- Test switch and LED indicators are mounted on the visible bottom panel
- Units mount quickly and easily in standard 2' x 2' or 2' x 4' grids without any additional hardware
- Solid-state pulse-type charger – current-limited, temperature-compensated, short-circuit proof and reverse-polarity protected
- Unit comes standard with electronic lockout and brownout circuits
- Sealed dust-proof transfer relay, test switch and LED indicator lights
- Long-life, maintenance-free Lead Acid battery
- Standard 120/347VAC input voltage
- NEXUS® compatible (for more information on NEXUS®, please consult your sales representative)
- CSA C22.2 No. 141-15 certified
- Available with a selection of 4W, 5W or 6W LED lamps
- Vandal resistance clear polycarbonate lens
- Optional tamper-proof screws available

Type: _____
 Project/Location: _____
 Contractor: _____
 Prepared By: _____
 Date: _____
 Model No.: _____



DIMENSIONS

Dimensions are approximate and subject to change.

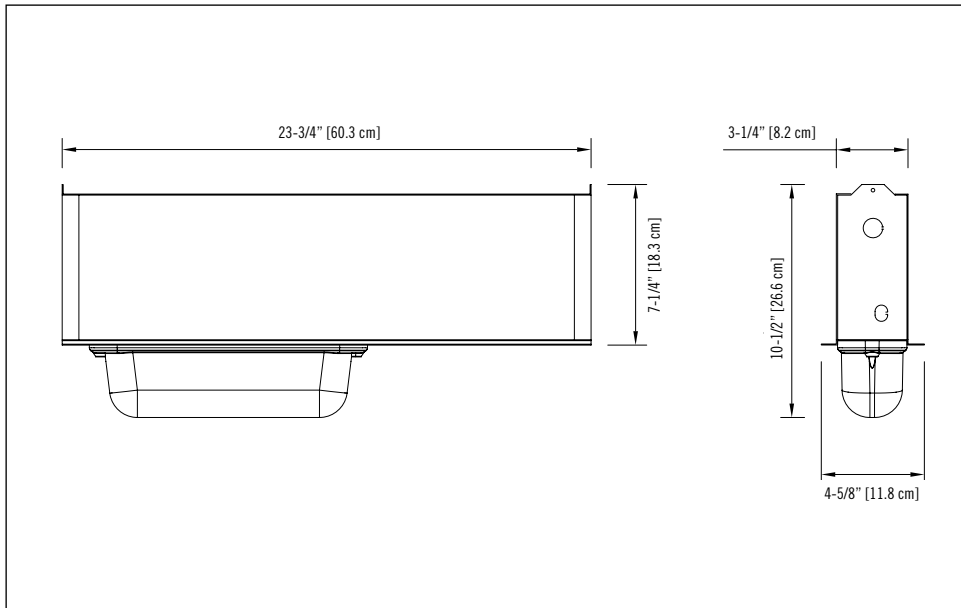

LDX-TS SERIES

T-Bar 12V MR16 LED Unit

ORDERING INFORMATION

SERIES	CAPACITY	SPECIAL OPTIONS	# OF HEADS	LAMP WATTAGE	COLOUR	A.C. VOLTAGE	OPTIONS
LDX12= 12V	36TS= 36W 72TS= 72W	Blank= standard AD= auto-diagnostics, audible ADN= auto-diagnostics, non-audible NEX= NEXUS® wired system interface* NEXRF= Wireless NEXUS® system interface*	2= two heads 3= three heads	LD7= MR16 LED, 12V-4W LD9= MR16 LED, 12V-5W LD10= MR16 LED, 12V-6W	Blank= factory white	Blank= 120/347VAC input	CT= cabtire D= time delay (programmable) IT= AC terminal block ITOT= AC/DC terminal block LB= light activated test switch LD= lamp disconnect OT= DC terminal block TL= twist lock plug (120V)** TP= tamper-proof screws***
		* Not all options available with NEXUS® System. Please consult your sales representative.					**120V is standard ***990.0119-RL= tamper proof bit (sold separately)

EXAMPLE: LDX1236TS2LD70T